

MTI E-Mail on Android

The following steps are required to configure Microsoft Exchange ActiveSync on most Android phones or tablets. Settings may vary by brand and model.

1. Locate your **Settings icon** within your App Drawer.

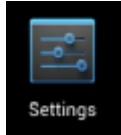

2. Within Settings, scroll down and select **Add Account**.

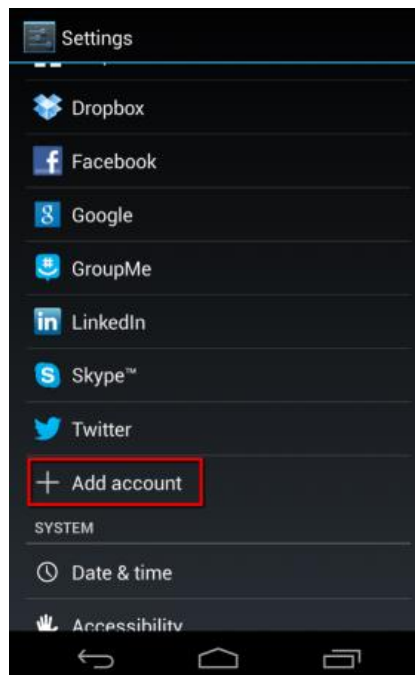

3. Select **Corporate** for your account type.

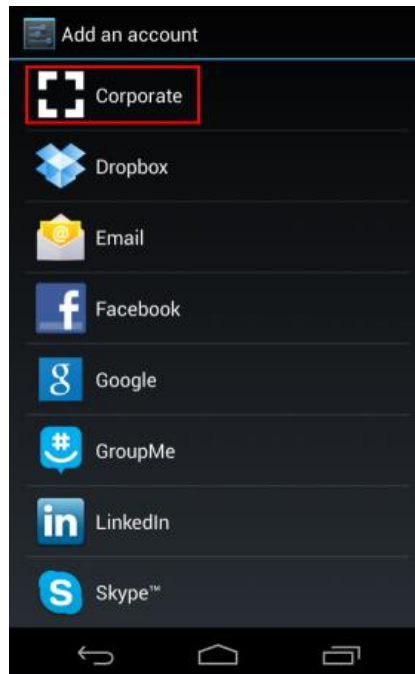

4. Enter your Email Address and Password, then select **Next**.

5. In the Domain\Username field enter AD\username (Example: AD\Smith123). In the server field enter

mail.mitchelltech.edu

Select the **Next** button.

Account setup

Domain\Username
user@domain.com

Password
.....

Server
connect.emailsrvr.com

☒ Use secure connection (SSL)
☐ Accept all SSL certificates

Client certificate
None Select

Port
443

Mobile Device ID

Previous Next

6. You will be presented with a Security Administration prompt. Select **OK**.

Account setup

☐ Accept all SSL certificates

Client certificate
None Select

Port

Remote security administration

The server connect.emailsrvr.com requires that you allow it to remotely control some security features of your Android device. Do you want to finish setting up this account?

Cancel OK

Next

7. Select the options to sync then press **Next**.

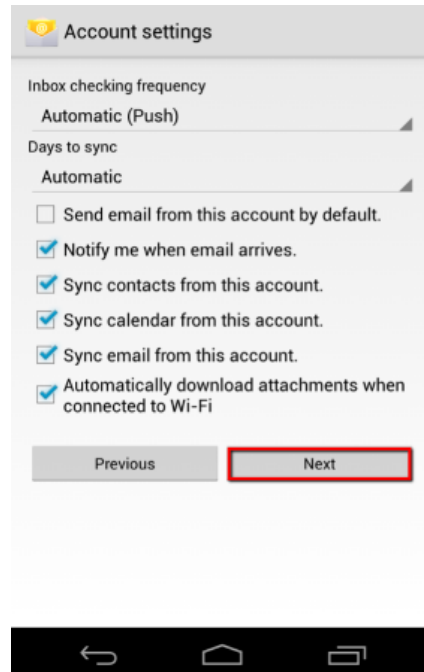

8. Name your account with a name of your choice, then select **Next** and the setup will be complete.

